

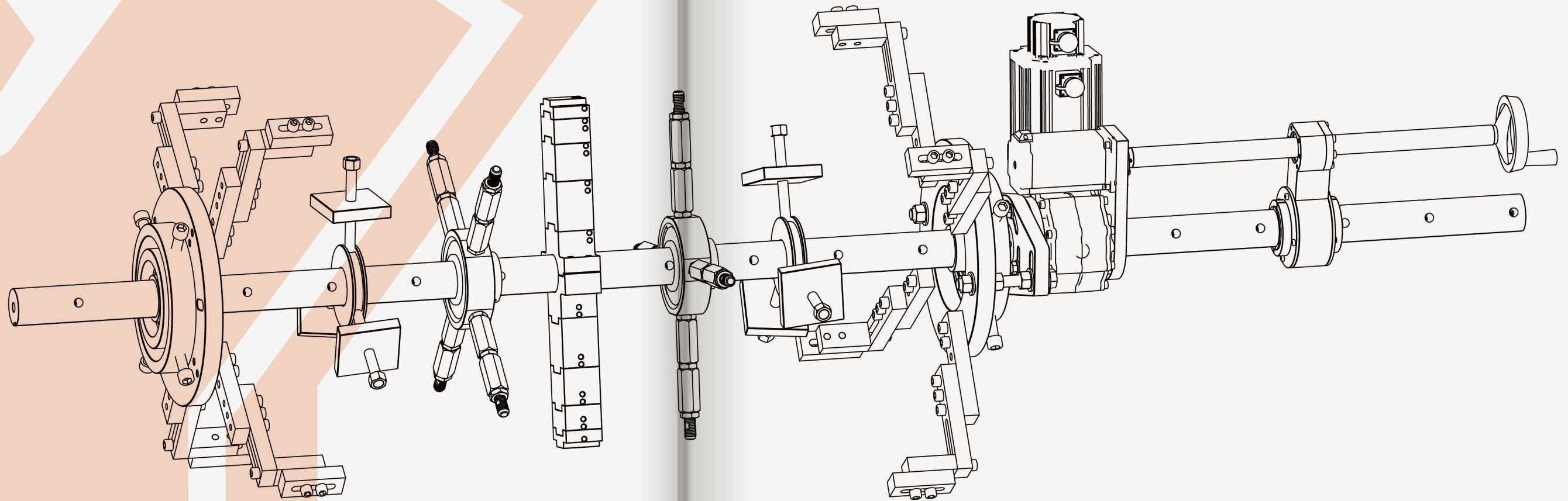

BOS-DS60

Portable Line Boring Machine

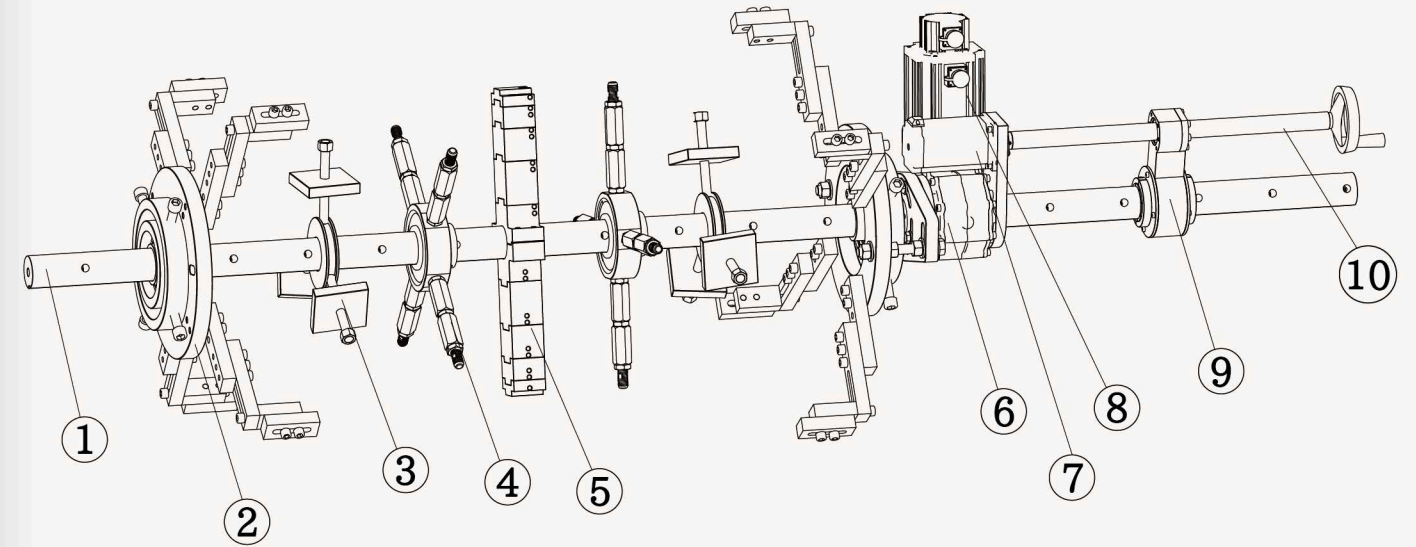

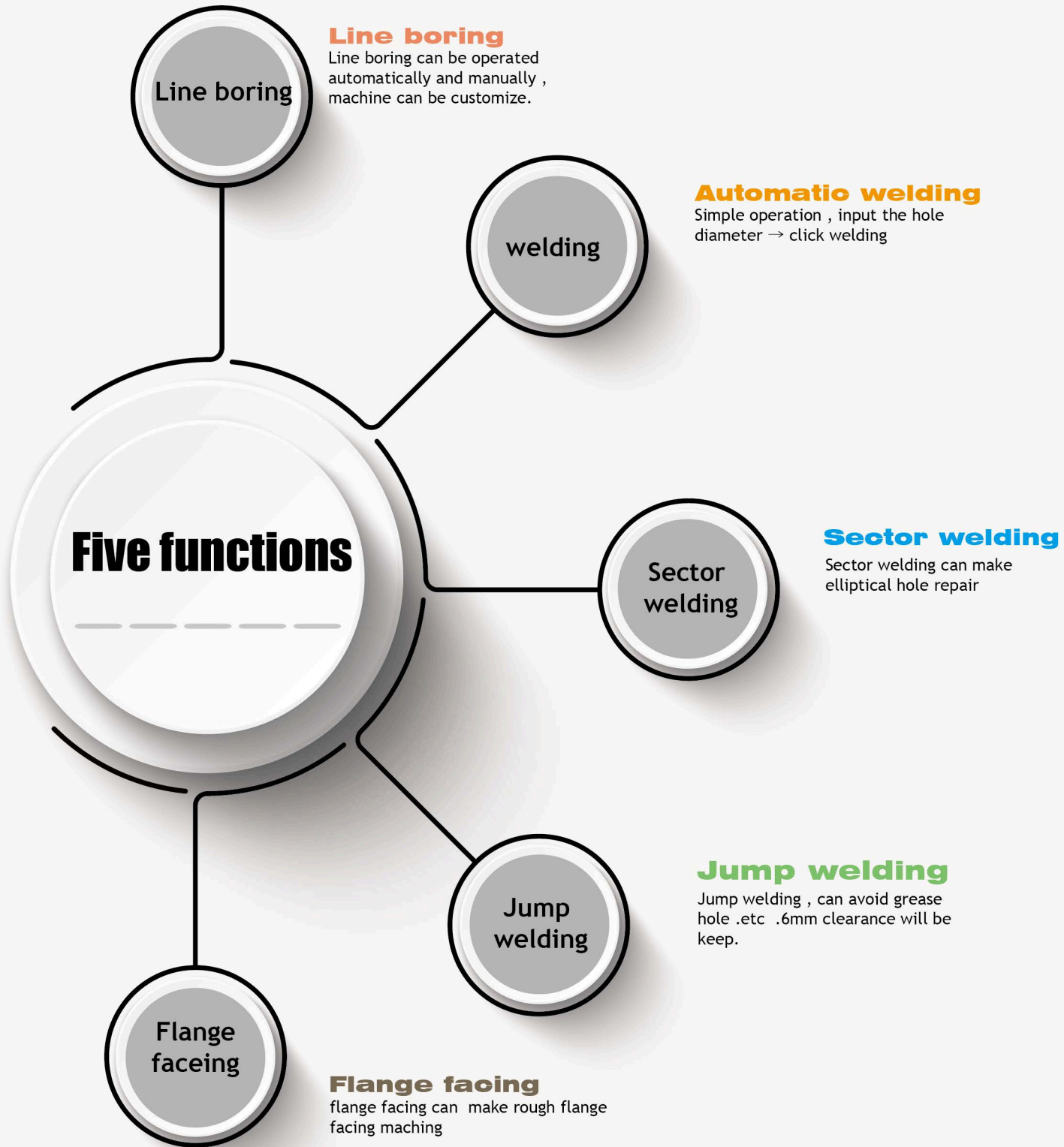

- ① • Line boring bar
- ② • Spherical bearing support frame
- ③ • Bearing support assembly
- ④ • Alignment and bearing
- ⑤ • Big tool holder
- ⑥ • Gearbox
- ⑦ • Axial feed motor
- ⑧ • Servo motor
- ⑨ • Axial feed frame assembly
- ⑩ • Axial feed screw bar

STEP 01 Machining range

It can handle inner holes with diameters between 65mm and 600mm. This versatile tool that is used in many industries. Its accuracy can reach 0.02mm, and the ovality tolerance 0.02mm, which ensures high-quality machining .

STEP 02 High-Quality servo motor

S60 use high-quality servo motor to ensure the durability and precision of works. This kind of motor has the characteristics of long life, and the reliability is very high.

STEP 03 Small size and light weight

One of the advantages , its small size and light weight. it can be easily carried and operated. This is especially important for users who need to move frequently on mobile devices.

STEP 04 Multiple scenarios

S60 is suitable for a variety of scenarios. Whether it is the repair of the shaft hole of construction machinery, or the repair of the shaft hole of mining machinery, or the repair of the shaft hole of port machinery, ship maintenance or production shaft hole processing, or even thermal power equipment, it can give full play to its function.

H • hertz:50Hz/60Hz

V • Voltage:220V/380V

W • power: 3800w

ADC • Cut width:0.02-1mm

N • Speed:30-133rpm

Φ • Line boring bar diameter:Φ60mm

F • Axial feed speed:0- 0.5(s)

mm • Standard line boring bar length:2200mm

Φ • Line boring diameter:65-600mm

Φ • Welding diameter:65-600mm

E • Axial machining length:by bearing quantity

H • weld width:3mm

L • Axial machining depth: 1.5 mm

Φ • weld thickness:Φ6-8mm

ae • Radial machining width:0.03-3mm

co2 • Applicable welding machine type:co2

CV • Speed regulation:Stepless speed regulation

Φ • Recommended wire diameter:0.8/1.0/1.2

N.m • Output torque:220N.m

V • Recommended welding machine model:Power 210 - Power 500

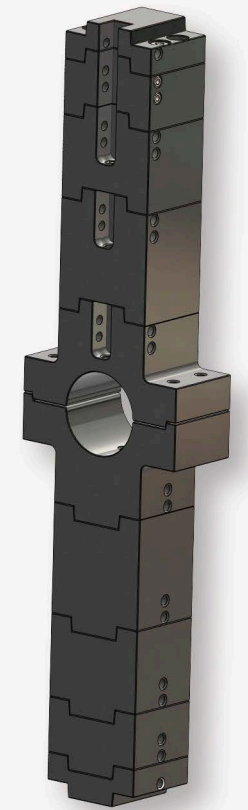
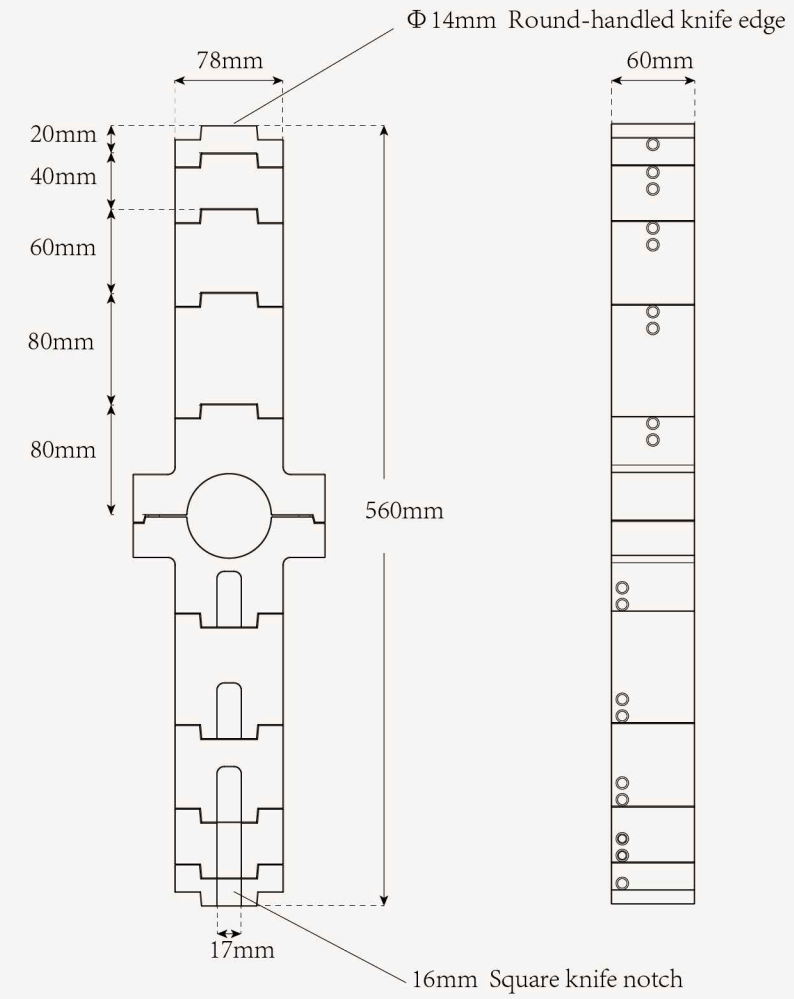
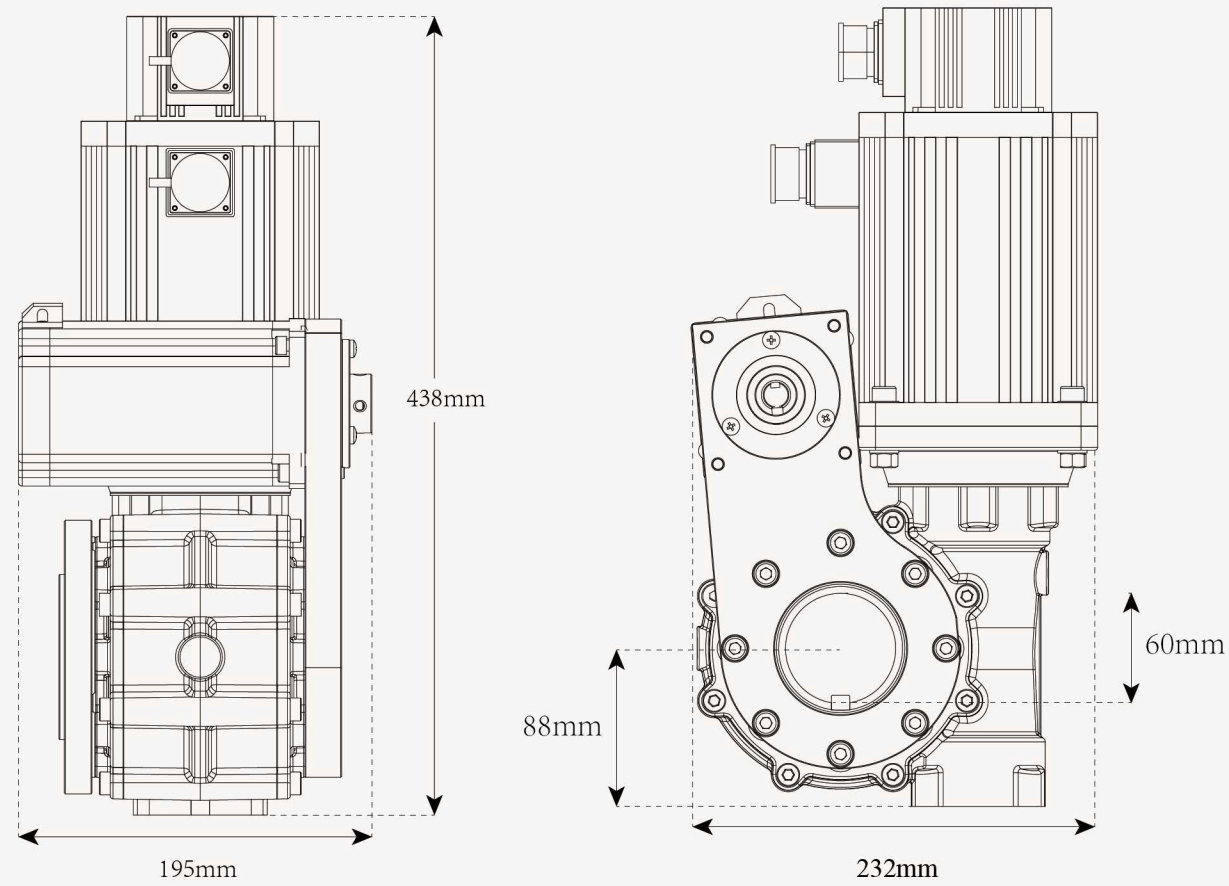

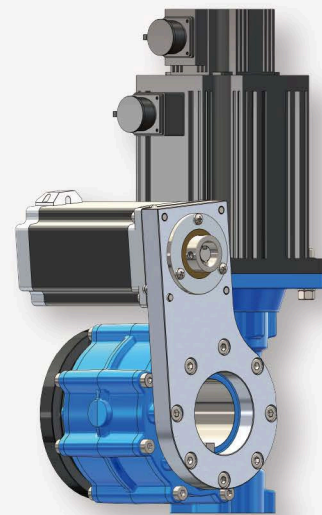

- H** • hertz:50/60Hz
- W** • power: 3100w
- N** • Output speed:30-130rpm
- F** • Axial feed speed:0- 0.5 (s)
- V** • Voltage:220V/380V



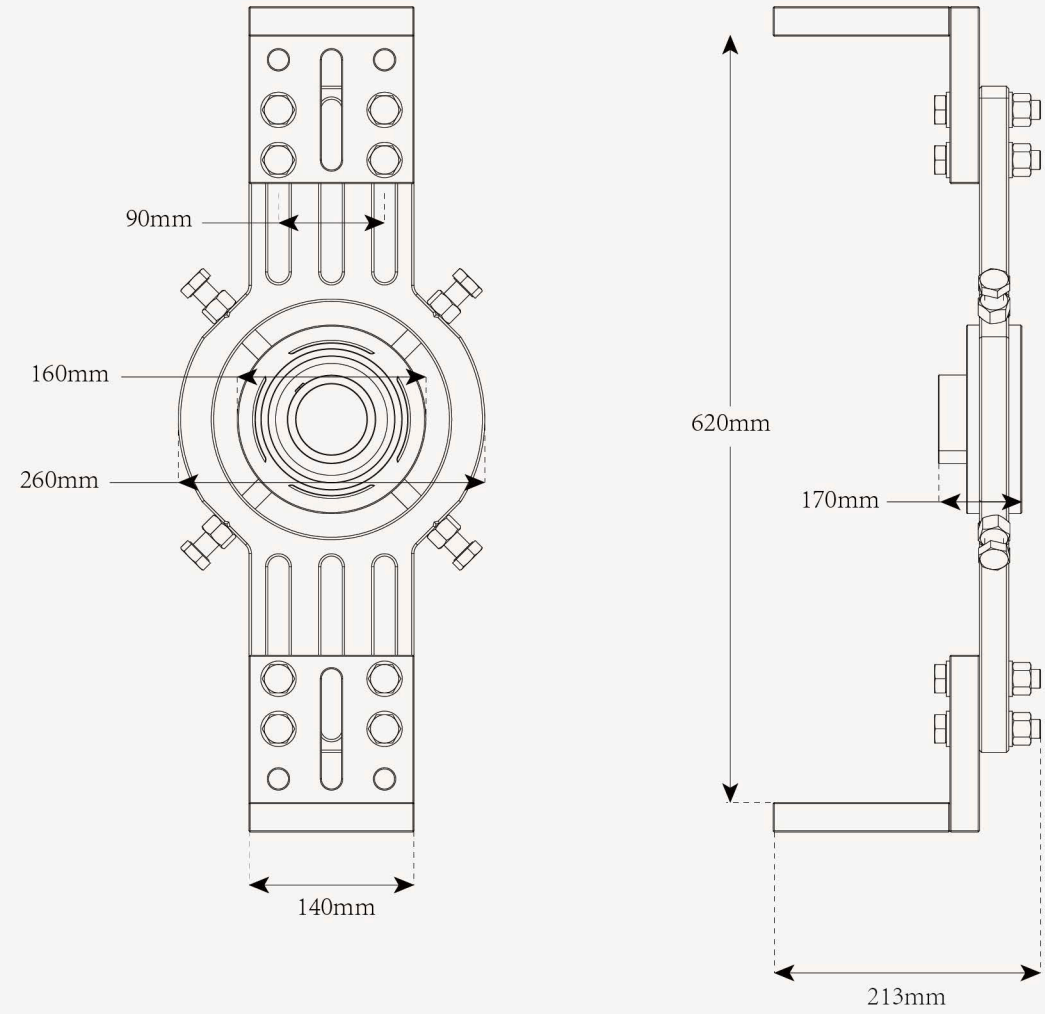

- Hexagon icon** • S60Line boring machine has a patented "modular tool holder", which is more convenient to carry than the traditional single-size tool holder, and it can be better adapted to any size of the bores .

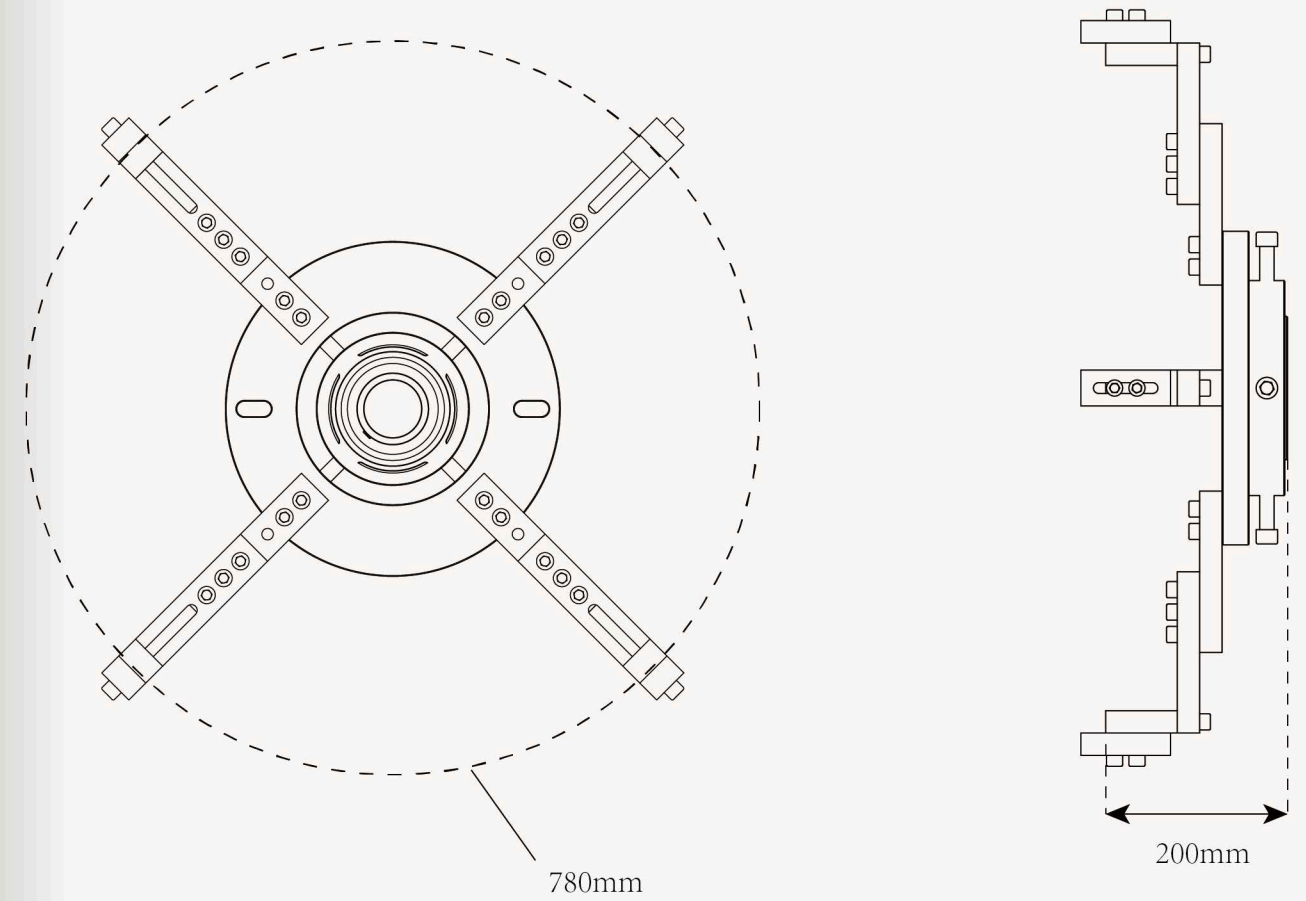
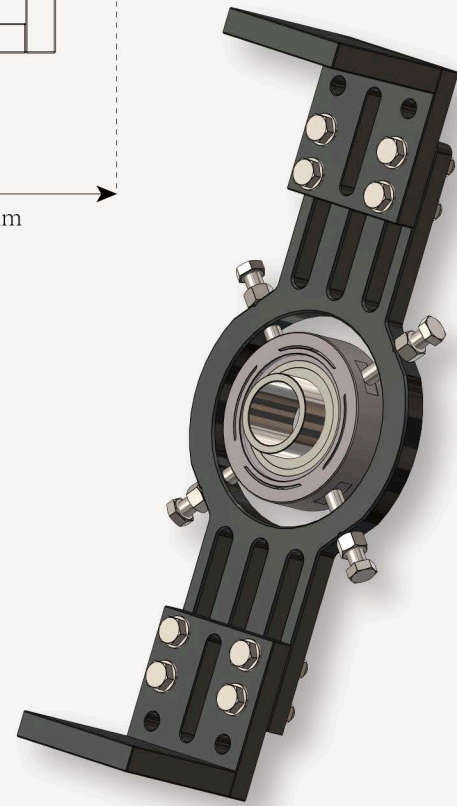

-  • Double-arm bearing mounts
-  • Maximum support diameter: 170-620mm



-  • Cross-type bearing mounts
-  • Maximum support diameter: 180-780 mm

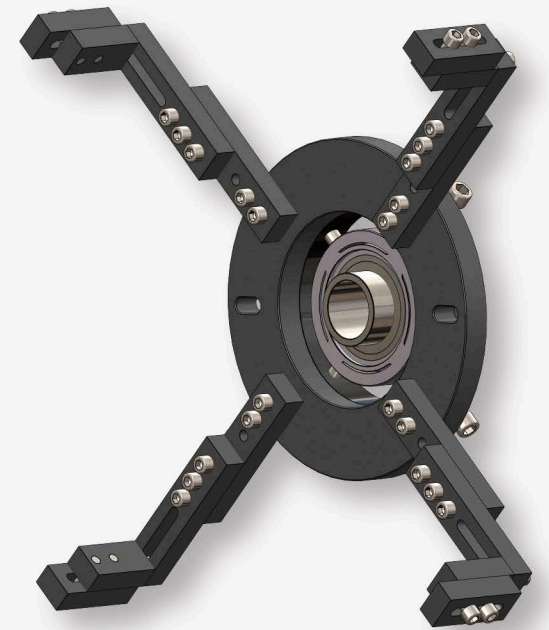

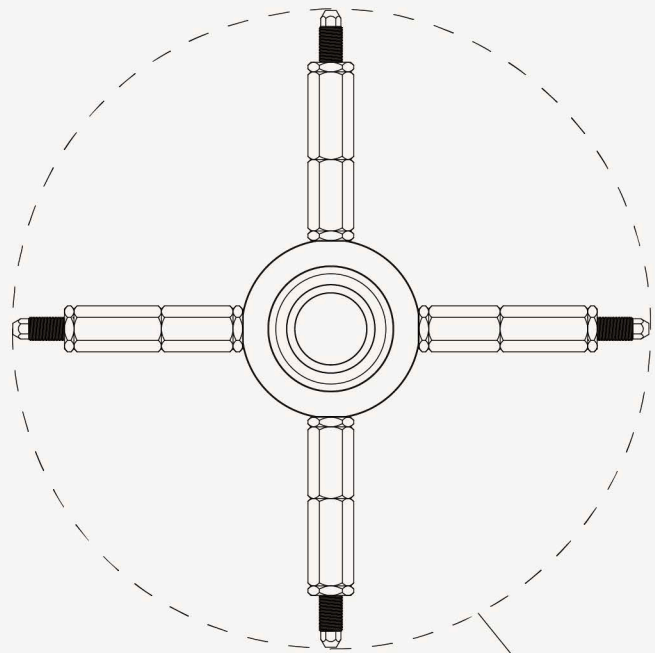

Φ 340mm-650mm

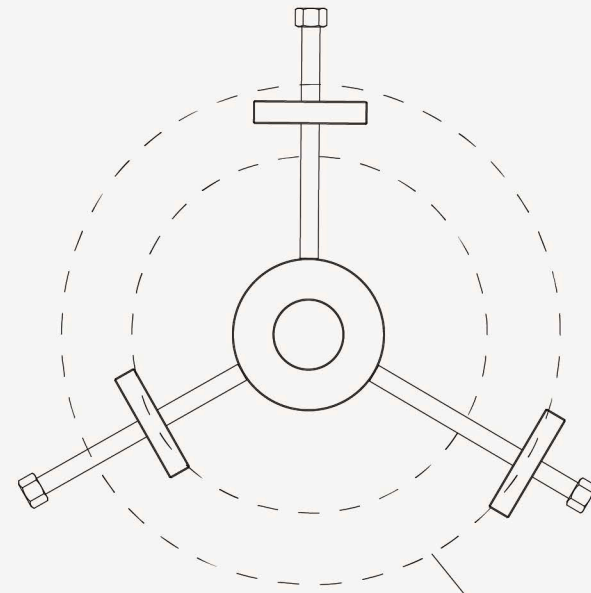

Φ 140mm-360mm



- Spherical bearing centering device
 Suitable for inner bore with inner diameter 300mm-600mm

- Three-way centering device
 External welding fixation
 Scope of work: 150-300mm

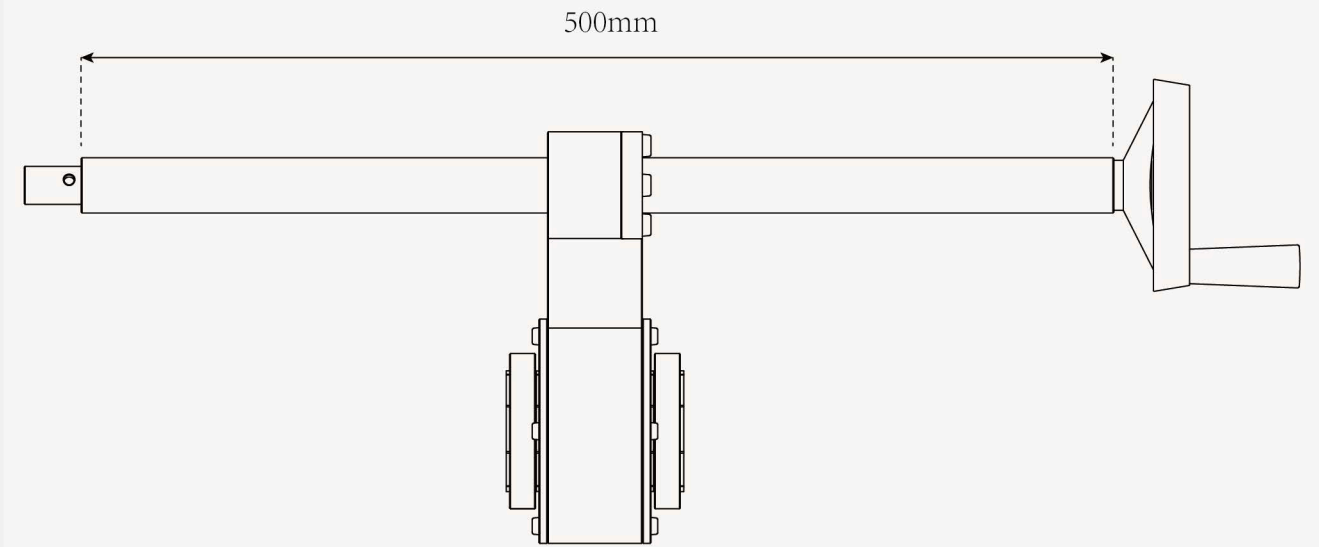

- Standard length: 600mm
- The maximum length that can be customized is: 1000mm

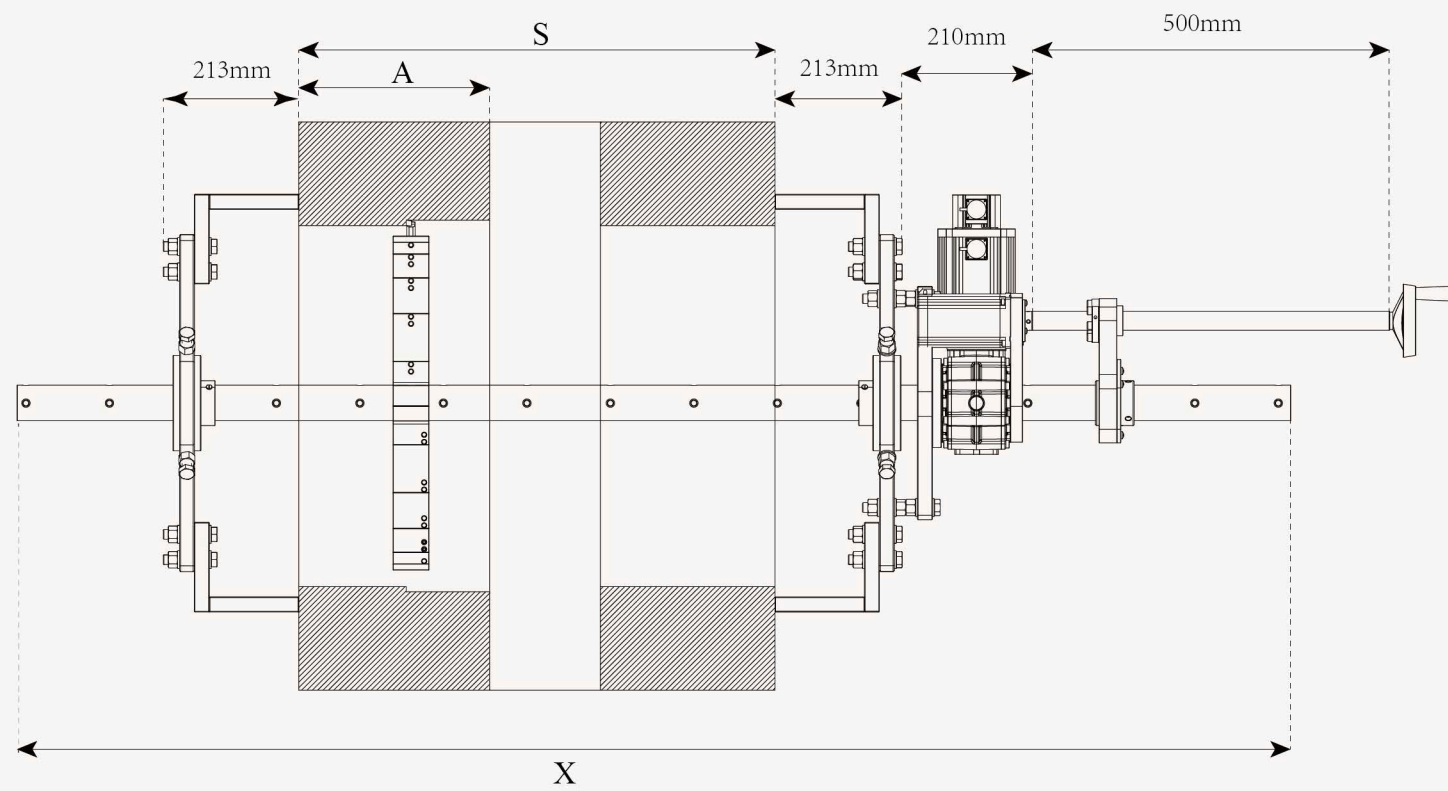
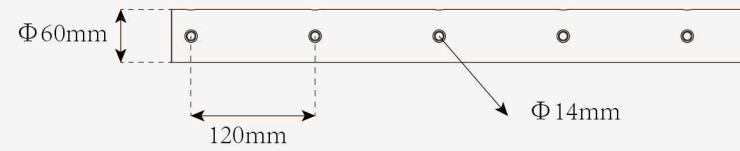

Custom line boring bars length.

Calculation formula

- (X)Line boring bar length =
 (S)The total length of the workpiece +
 (A)Processing length +
 (1136mm)S60 line boring machine required length

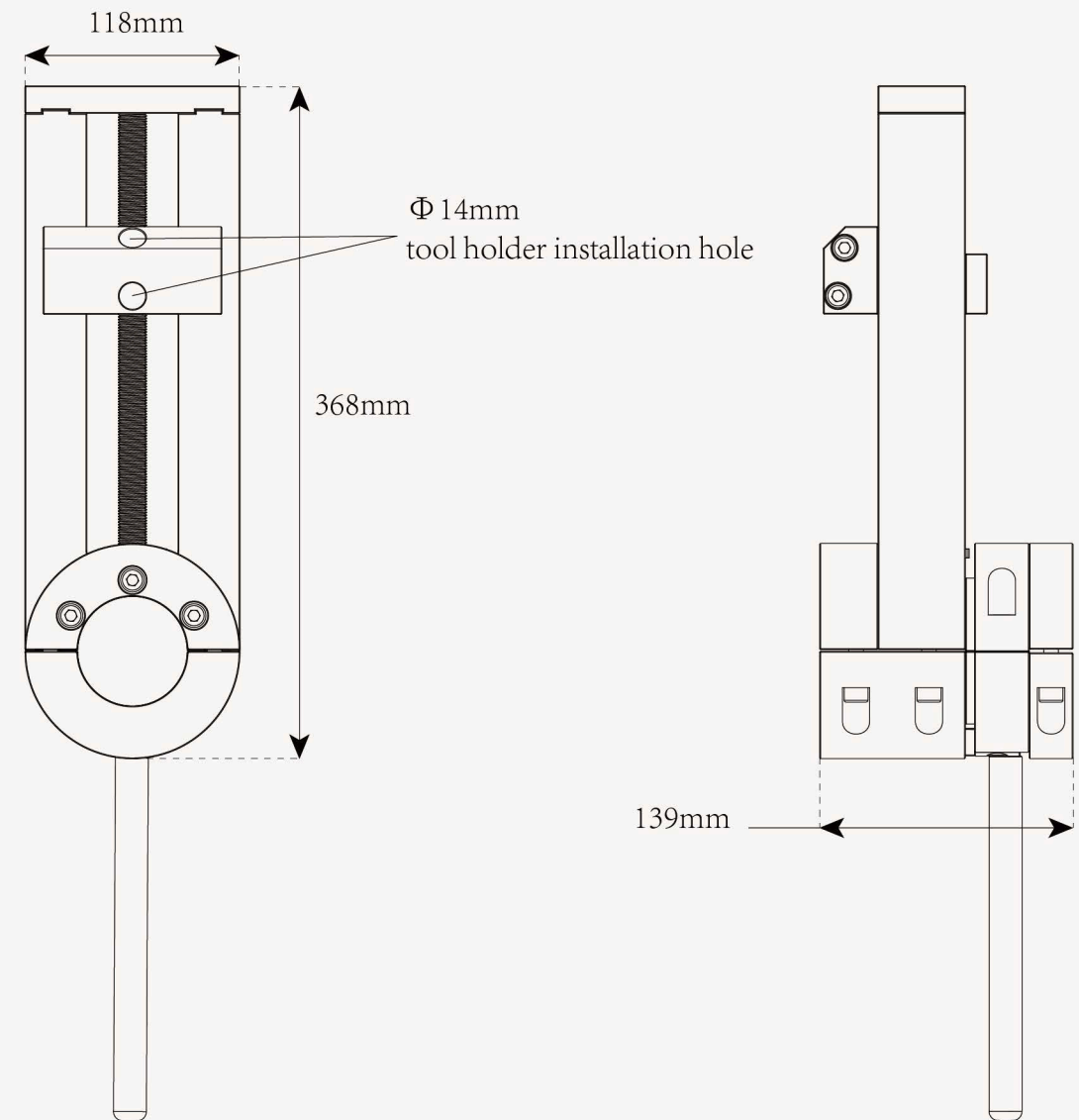

- Radial feed method: automatic
- Flange facing: 160-600mm



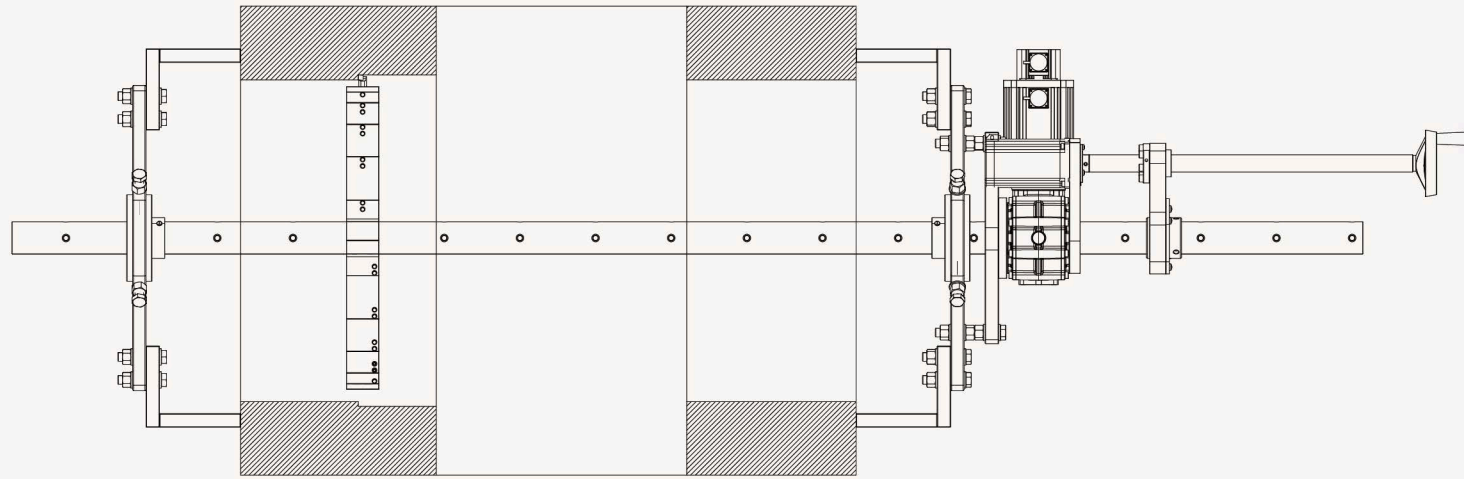

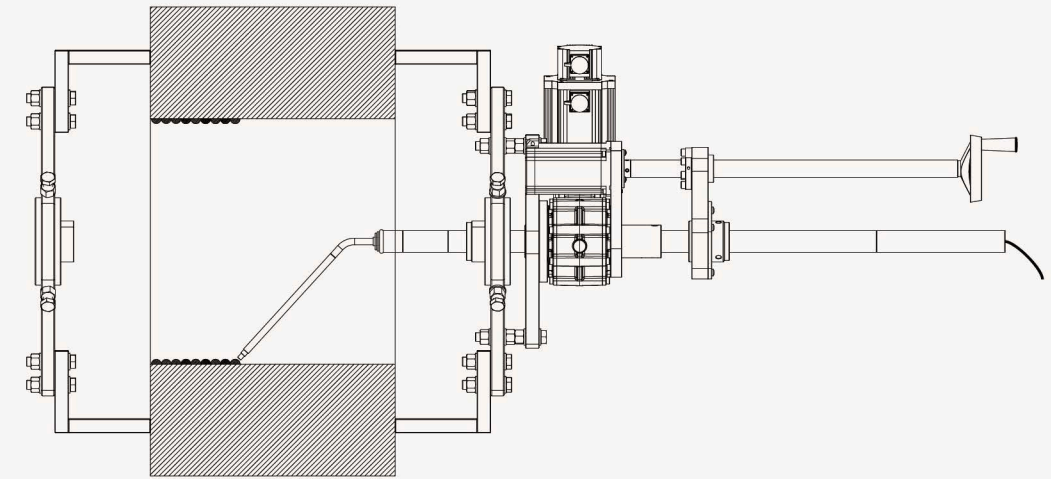

- mm • Forward and reverse operations
- Φ • Axial feed supports forward and reverse operations.
- mm • Boring bar length: 2200 mm
- Φ • Line boring diameter: 65-600mm
- E • Axial machining length: 0.5-1000mm
- H • Surface roughness: Ra 3.2(25) μm
- Ap • Radial cutting width: 0-3 mm
- Ae • Axial cut depth: 0-1.5 mm
- φ • Ellipticity tolerance: ±0.02mm
- X° • Taper angle tolerance for internal hole cutting: ±0.02

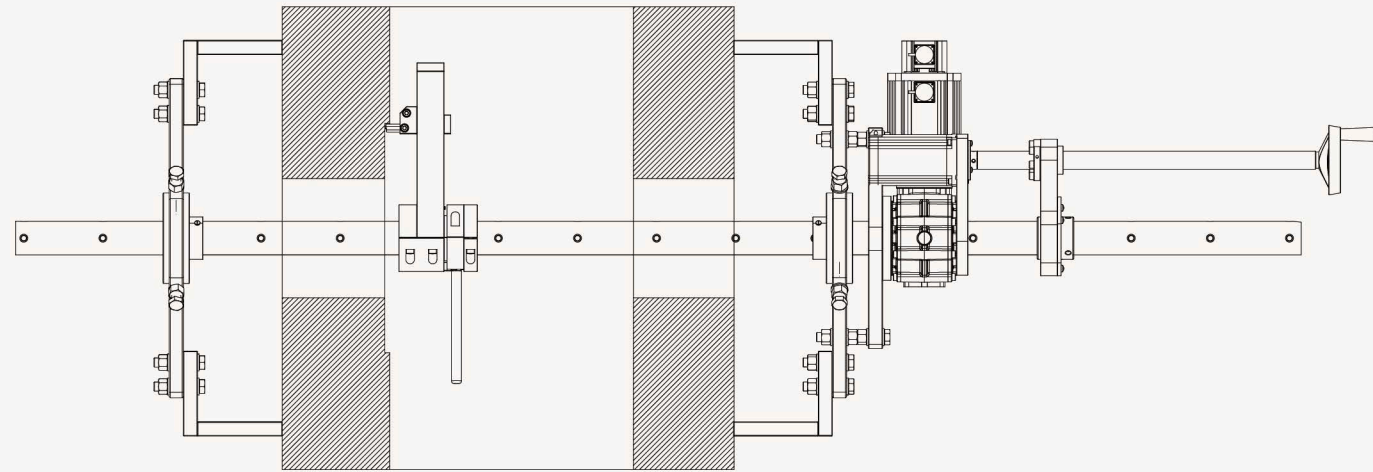

- L • Welding torch empty tube length: 200/240/300/800mm
- Φ • Welding diameter: 65-600mm
- L • Welding Gun Cable Length: 4540mm
- H • The axial welding length is less than 1000mm
- W • weld width W=3-4mm
- Ae • Axial cut depth: 0-1.5 mm
- W • Intermittent welding width: 15mm
- W • Sector welding width: 4-299mm



Flange Face Application

-  • Machining range: 160-600mm
-  • Speed: 30-133rpm

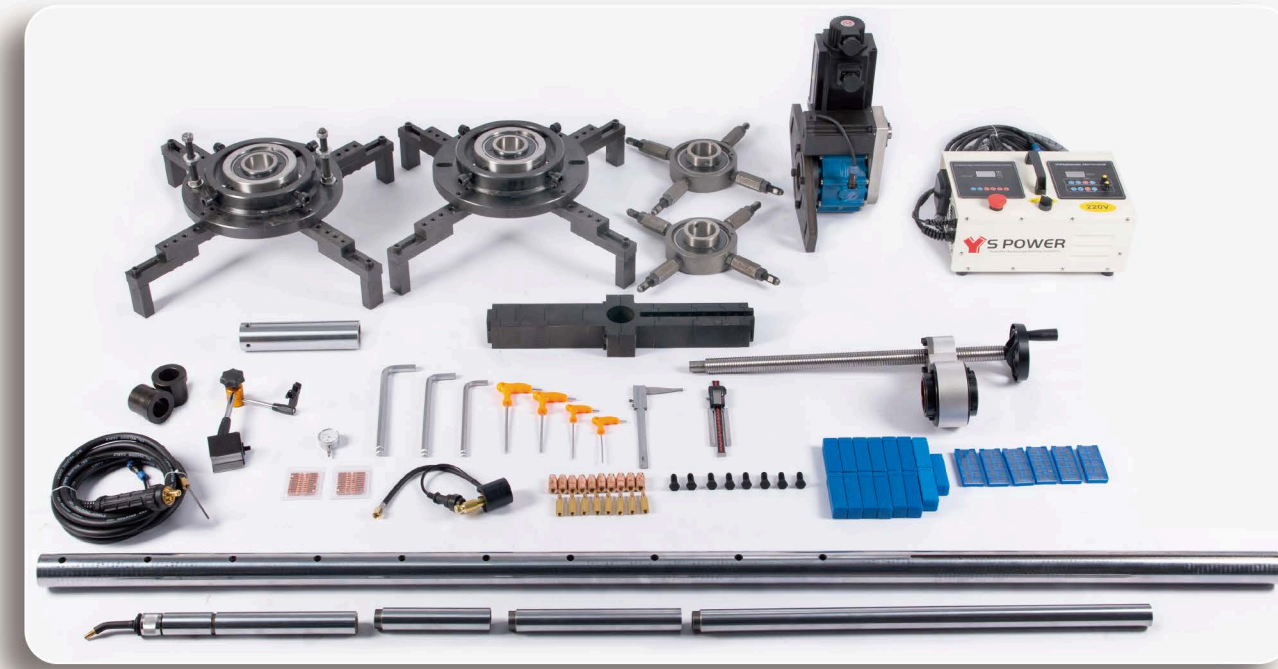

-  •
-  •



BOS-DS60 wire boring

Servo motor is adopted
High precision:
The servo motor has:
High precision
position control capability,
It can be achieved
to the tool position
Very precise control,
Helps to improve
Machining accuracy and
Repeatable positioning accuracy.

BOS-DS60 welding

precise program control, input
aperture,
Internal procedures will be based on
Data on the diameter of the inner bore
Calculated automatically
Required rotational speed and
axial feed,
Click on welding to get started